



studiotech
**WHITE ROSE
SHOPPING CENTRE**

CLIENT Morgan Sindall

DESIGNER The Harris Partnership

CONCEPT As part of the new leisure extension, White Rose, The Harris Partnership designed a harmonious public realm to complement the existing shopping centre.

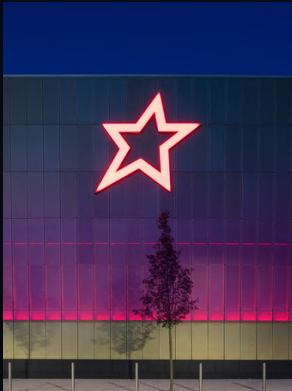
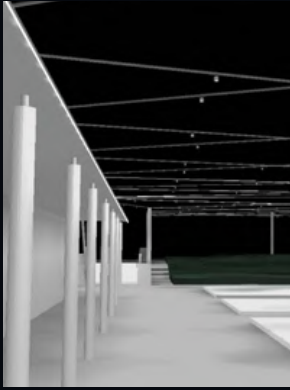
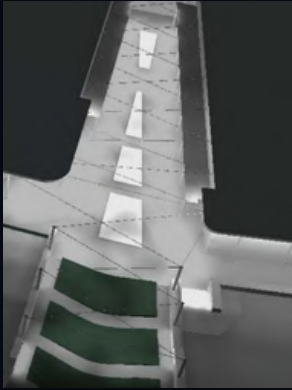

SOLUTION

Studiotech was responsible for the lighting throughout the extension. This included the catenary lighting suspended above the public realm, recessed linear amenity lighting and dynamic colour changing RGB LED lighting to the cinema façade plus handrail lighting and tensile canopy lighting in the play area.

PRODUCT

The installation of the catenary mounted luminaires above the public realm required a considerable amount of design and engineering including manufacturing the steel rope to exact lengths, supplying and installing 7m high columns to fix to, engineering bespoke brackets and calculating the exact tension required for the lighting to remain taught.

EXPERIENCE

As part of the wider public realm scheme, the lighting creates a holistic flow throughout the customer journey, from the main thoroughfare through to the cinema and children's play area.

